



# IMAP MANUAL

AN INSTRUCTIONAL GUIDE TO VIEWING  
AND MAPPING DISTRICT POLYGONS ONLINE



2025

LAST UPDATE: SEP, 2025

## TABLE OF CONTENTS

Introduction	1
IMAP at-a-glance	2
Logging In	3,4
Understanding The Components Of IMAP	5,6
Buttons and Features	
Districts Box	7
Work In Progress Box	8
To Be Verified Box	9
Committed Box	10
Map Display	11,12
Viewing A Polygon	13,14
Viewing A Polygon - Alternate Method	15
Adding a Polygon	16,17
Deleting A Polygon	18
Modifying A Polygon	19,20
The Polygon Transaction Process	
Explanation	21
Districts Box	22
Work In Progress Box	23
To Be Verified Box	24
Committed Box	25
Exiting IMAP	26
Activation Date for New or Changed Polygons	26
APPENDIX	
Polygons Drawn Outside County Boundaries	A1

## INTRODUCTION

IMAP is an online application that allows underground facility owners to view, add, modify and delete polygons from their active database. The following pages will explain the process you must follow to accurately work on your database with the **Utility Notification Center** using **IMAP**.

We recommend that you have IMAP up and running while you read this manual, so that you can try out certain features as you learn about them. Welcome to IMAP!



# IMAP

Here's a quick rundown of how IMAP is used to help get Facility Operators notified quickly and accurately.

After the new **DATABASE POLYGON** has been added to the database maps, Prism works with this new information so when a **NOTIFICATION POLYGON** is drawn in the area near the newly added facility, the user is directly informed.

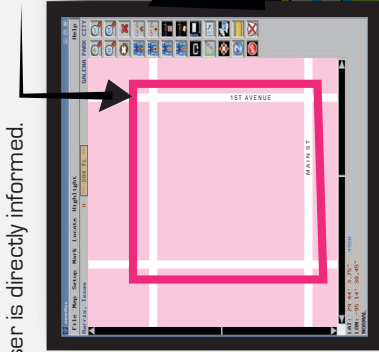

Prism's map interface, showing a **NOTIFICATION POLYGON** being drawn

Here, you can see the **NOTIFICATION POLYGON** covers a portion of the new database polygon that was added by the user. Now that the user has successfully added the database polygon to the map, Prism will automatically notify the user.

After logging into the IMAP system, the user adds a **DATABASE POLYGON** into the base map showing the whereabouts of a particular facility. This process allows them to be notified when work is being done near this area, through occ's PRISM technology.

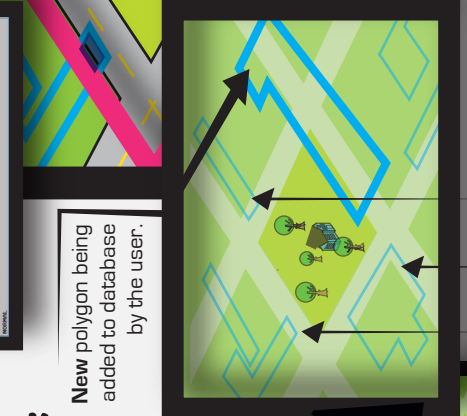

New polygon being added to database by the user.

The user wants to create a new **DATABASE POLYGON** within the base map for future notifications for a specific area(s) - They log in to IMAP.

Existing database polygons already 'in' our database system.

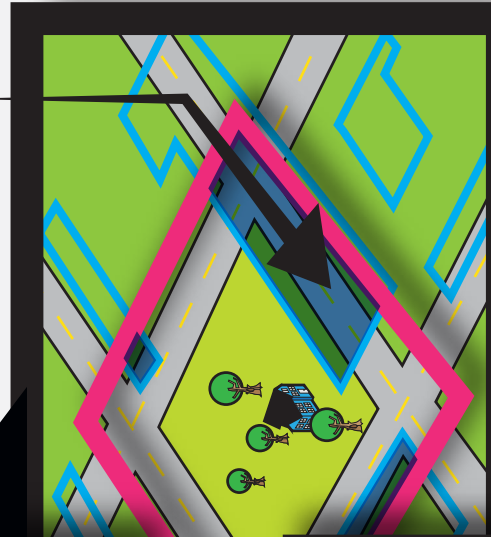

## LOGGING IN TO IMAP

Step 1: go to <https://wa.itic.occinc.com>

Step 2: At the Washington One Call IT-ICnxt Login Screen enter your login and password and click Login.

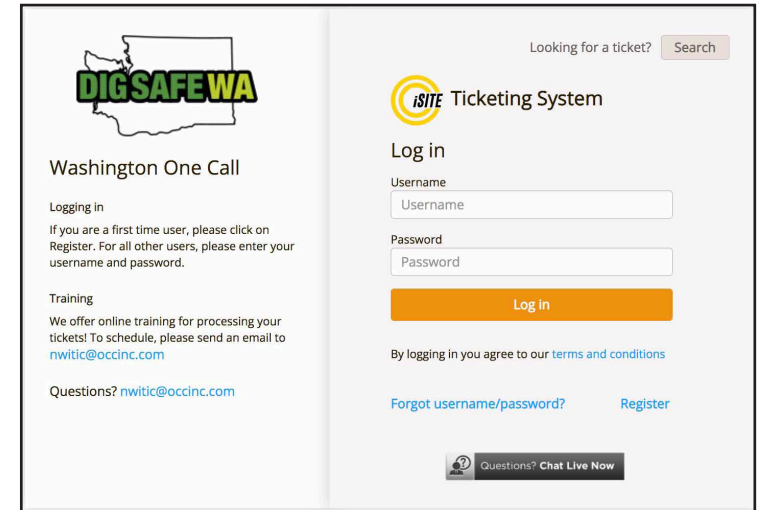

Step 3: Click the Legacy Application button. You may get a pop-up message – if so, click the Legacy button.

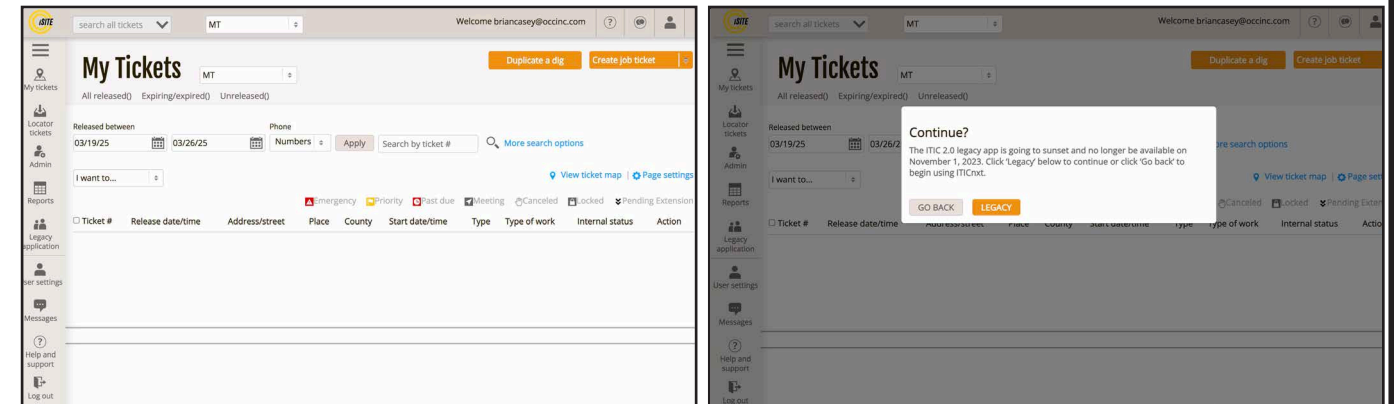

Step 4: At the Legacy Application menu click "Edit Member Map" to access IMAP.

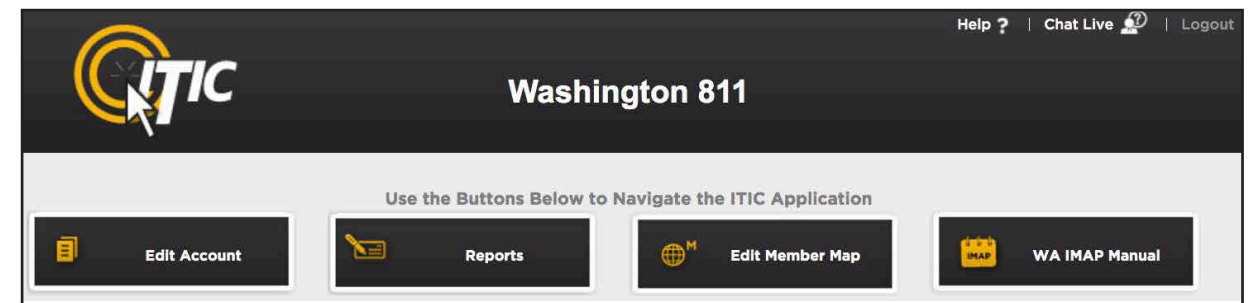

3. At the **UTILITY NOTIFICATION CENTER Login/Registration Screen** enter your email address and password and click **Login**.

Login/Registration Screen

Then click "Edit Member Map" to access IMAP.

ITIC Main Menu Screen

**REMEMBER:** IF YOU CLICK THE 'BACK' AND 'NEXT' BUTTONS AT THE TOP OF YOUR BROWSER (i.e. FIREFOX, INTERNET EXPLORER, SAFARI etc.). ALL THE INFORMATION ALREADY ENTERED WILL BE DELETED!

## UNDERSTANDING THE COMPONENTS OF IMAP

[After Clicking 'Edit Member Map' on the Main Menu]

The **Location Information** box will appear. The Location Information box is used to select the state, county, and district code you would like to work with.

Location Information Screen

Once you have made your selections within the Location Information box, click **GO!**

The rest of the IMAP components will appear. You will see four similar boxes, labeled **Districts**, **Work In Progress**, **To Be Verified**, and **Committed**.

The **Districts**, **Work In Progress**, **To Be Verified**, and **Committed** boxes are used to create "transactions" which are specific instructions for deleting, editing, or creating new district polygons. They also display information on currently active polygons, or pending transactions.

Below these four, you will see the **Map Display**. (Next Page)

## UNDERSTANDING THE COMPONENTS OF IMAP (Continued)

The **Map display** is the geographic context in which you create **new**, and edit or delete **existing** notification polygon(s). It can also be used to view your currently active district polygons on the map.

**Map Display - MAP view (Google)**

Verify polys on OCC map only.

Search Results: [dropdown]

OCC Satellite Google

Map data ©2012 Google - Terms of Use Report a map error

Place: LONGVIEW KILSO  
Grid: T-8N R-2W S-36NE  
Lat: 46.135221  
Lon: -122.874983

Highlight:  
Segment Len:  
Total Len:

Display  
Identify  
Measure  
Placemark

OCC Satellite Google

### PLEASE NOTE:

When initially loading the Map display, you will be presented with a Google-based map. Another viewing option, OCC, is our internal map, which you will need to select before you may confirm any transactions. The third option, Satellite, is a combination of the Google map and satellite imagery.

Your map view can be changed by clicking the buttons in the upper-right corner of the map interface.

## BUTTONS AND FEATURES

Now that we have reviewed the basic components of IMAP, let's look at the buttons and features found in the **Districts**, **Work In Progress**, **To Be Verified**, and **Committed** boxes.

### DISTRICTS BOX

**Scroll to Beginning/End** • scrolls to the beginning or the end of the polygon list

**Scroll Fwd/Back** • scrolls back or forward one item on the polygon list

**Hide/Show** • Click this button to hide (or 'minimize') the selected box, or show it again after it has been hidden.

**Districts:** [Hide]

[<<] [>>]

Scroll To [input field]

Map	Record ID	Map Ref	Ring ID
<input type="checkbox"/>	5233258	-	na
<input type="checkbox"/>	5233259	-	na
<input checked="" type="checkbox"/>	5233260	-	na

[Goto (1)] [Clr (1)] [All (3)] [History] [Modify] [Delete] [Delete All (3)]

**GoTo** • causes the map to zoom in and center on the currently selected polygon(s).

**Clr** • "unchecks" any currently selected polygons in the **Districts** box.

**History** • displays some history information on the district polygon or transaction.

**Delete** • removes the selected polygon from the database. This will create a transaction, which will appear under the **Work In Progress** box.

**All** • selects all polygons in the selected county and district.

**Modify** • edits the currently selected active polygon. This will create a transaction, which will appear under the **Work In Progress** box.

**Delete All** • removes all polygons in the **Districts** box. This will create several transactions, all of which will appear in the **Work In Progress** box.

## BUTTONS AND FEATURES (Continued)

### WORK IN PROGRESS BOX

**GoTo** • causes the map to zoom in and center on the currently selected polygon(s).

**Edit** • allows edits to be made to the currently selected transaction. The edits can be made using the **map interface** (see the section on **Modifying a Polygon** on page 19 for instructions on how to manipulate polygons.).

**Hide/Show** • Click this button to hide (or 'minimize') the selected box, or show it again after it has been hidden.

#### Work In Progress Box

#### Work In Progress:

<< <<

Scroll To

Map	Type	Record ID	Map Ref	Eval Server	Act Date	User	Comments
<input type="checkbox"/>	ADD	3	-		11/30/2012	test@occinc.com	New
<input checked="" type="checkbox"/>	ADD	4	-		11/30/2012	test@occinc.com	New
<input type="checkbox"/>	ADD	5	-		11/30/2012	test@occinc.com	New
<input type="checkbox"/>	ADD	9	-		11/30/2012	test@occinc.com	New
<input type="checkbox"/>	ADD	10	-		11/30/2012	test@occinc.com	New

Goto (1) Clr (1) All (6)

History New Edit Submit Abort

Submit All (6) Abort All (6)

**History** • displays some history information on the district polygon or transaction.

**All** • selects all polygons in the selected county and district.

**Clr** • "unchecks" any currently selected polygons in the **Work In Progress** box.

**New** • creates a new district polygon. This will create a transaction, which will appear under the **Work In Progress** box.

**Submit** • submits the currently selected polygon transaction to the **To Be Verified** box for final review.

**Submit All** • submits all polygon transactions currently residing in the **Work In Progress** box to the **To Be Verified** box for final review.

**Abort** • terminates the selected transaction, removing it from the system entirely.

**Abort All** • terminates all polygon transactions currently residing in the **Work in Progress** box, removing them from the system entirely.

## BUTTONS AND FEATURES (Continued)

### TO BE VERIFIED BOX

**Approve** • approves the currently selected polygon transaction for processing. It will appear in the **Committed** box.

**Hide/Show** • Click this button to hide (or 'minimize') the selected box, or show it again after it has been hidden.

#### To Be Verified Box

#### To Be Verified:

<< <<

Scroll To

Map	Type	Record ID	Map Ref	Eval Server	Act Date	User	Comments
<input type="checkbox"/>	ADD	2	-		11/30/2012	test@occinc.com	Submit
<input type="checkbox"/>	ADD	7	-		11/30/2012	test@occinc.com	Submit
<input checked="" type="checkbox"/>	ADD	8	-		11/30/2012	test@occinc.com	Submit

Goto (1) Clr (1) All (3)

History Approve Reject

Approve All (3) Reject All (3)

**GoTo** • causes the map to zoom in and center on the currently selected polygon(s).

**Clr** • "unchecks" any currently selected polygons in the **To Be Verified** box.

**History** • displays some history information on the district polygon or transaction.

**Reject** • sends the currently selected polygon transaction back to the **Work in Progress** box for modification or deletion.

**All** • selects all polygons in the selected county and district.

**Approve All** • approves all polygon transactions currently residing in the **To Be Verified** box for processing. They will appear in the **Committed** box.

**Reject All** • sends all polygon transactions currently residing in the **To Be Verified** box back to the **Work In Progress** box for modification or deletion.

## BUTTONS AND FEATURES (Continued)

### COMMITTED BOX

**Hide/Show** Click this button to hide (or 'minimize') the selected box, or show it again after it has been hidden.

Committed Box

Committed:

Hide

Scroll To

Map	Type	Record ID	Map Ref	Eval Server	Act Date	User	Comments
<input type="checkbox"/>	ADD	6	-		11/30/2012	test@occinc.com	Approve
<input type="checkbox"/>	MOD	5233258	-		11/19/2012	test@occinc.com	Approve
<input checked="" type="checkbox"/>	MOD	5233259	-		11/19/2012	test@occinc.com	Approve

Goto (1) Clr (1) All (3) History

**GoTo** causes the map to zoom in and center on the currently selected polygon(s).

**Clr** "unchecks" any currently selected polygons in the **Committed** box.

**All** selects all polygons in the selected county and district.

**History** displays some history information on the district polygon or transaction.

## MAP DISPLAY

Understanding how to navigate the map is an important part of learning to use IMAP effectively. **The following 2 pages** provide a detailed explanation of the functions and displays found within the mapping system.

### Zoom 'In' & 'Out' Bar

Zoom in by clicking on the plus (+) sign or by dragging the marker up on the bar. Zooming in will give more detail to the map. Zoom out by clicking on the minus (-) sign or by dragging the marker down on the bar. Zooming out will give less detail to the map while showing a larger area.

[You can also zoom in & out by using the middle-rolling button on your mouse when your mouse cursor is on the map.]

Map Display - MAP view (Google)

Verify polys on OCC map only.

Search Results:

OCC Satellite Google

Lat/Long Search

TICKET Search

TRSQ Search

Street Search

Place Indicator

Search Results

**NOTE:** holding your mouse cursor over one of the buttons will display a pop-up text, identifying the use of the button.

Place: LONGVIEW-KELSO  
Grid: T-8N R-2W S-36NE  
Lat: 46.135221  
Lon: -122.874983

Highlight:  
Segment Len:  
Total Len:

Display  
Identify  
Measure  
Placemark

## MAP DISPLAY (Continued)

## Mouse Cursor Functions

- Display
- Identify
- Measure
- Placemark

**Display:** The default setting for your mouse cursor. You will need to be in Display mode to use most of the functions of the map.

**Identify:** Select this function to identify roads, highways, rivers, creeks, etc., on the map that may not show a name. Address range information will also be displayed, if available. The info will appear in the bottom section of the map next to "Highlight." Zooming in on the map makes more names visible.

**Measure:** Use this function to measure the distance between points on the map. The info will appear in the bottom section of the map, under Segment Length and Total Length. In measure mode, right-clicking will add a placemark.

**Placemark:** The Placemark function is used to leave markers on the map, for later reference. This can be very helpful when used in conjunction with the Measure tool.

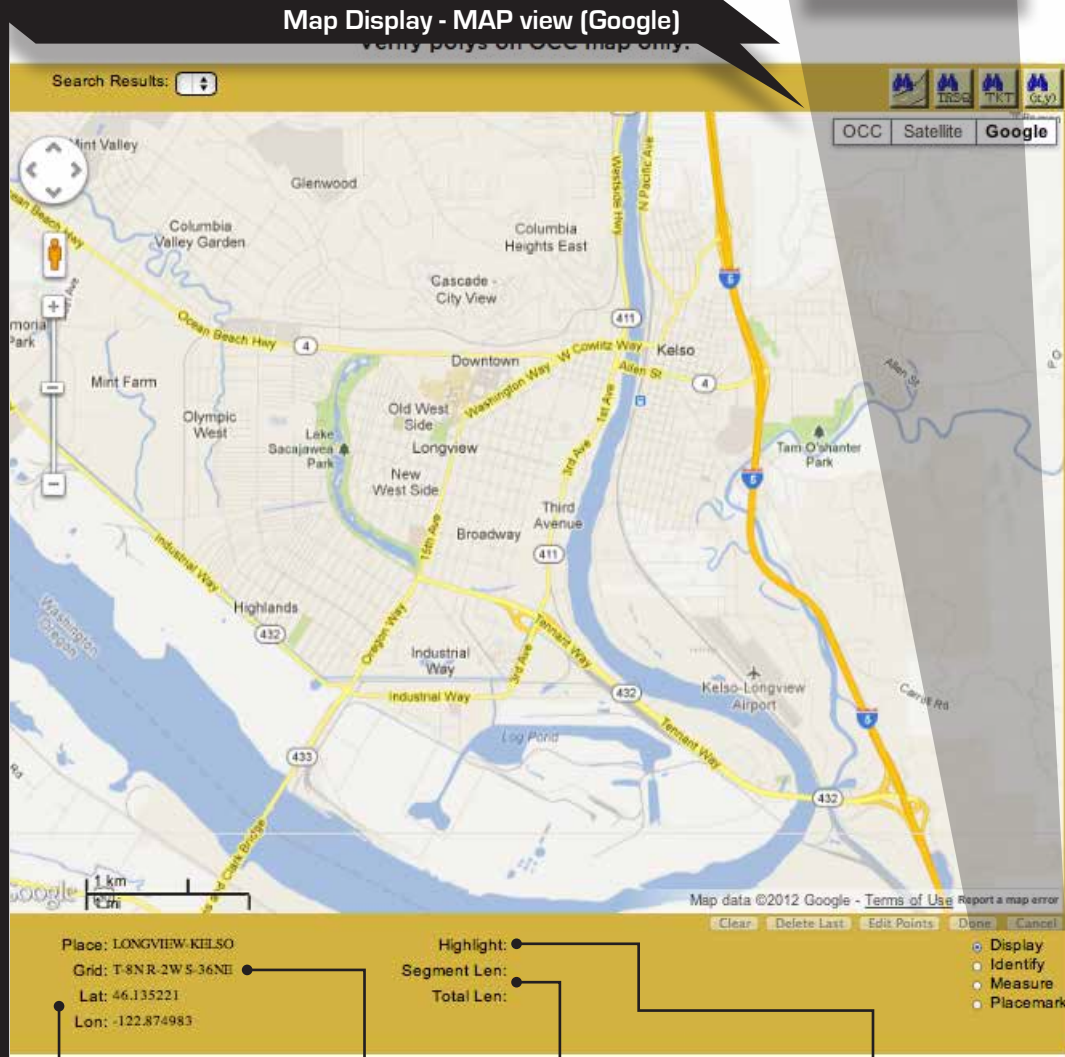

### Lat & Long Indicators

Displays the Latitude and Longitude where your mouse cursor is currently located.

### Grid Indicator

Displays the Township, Range & Section-Quarter (TRSQ) where the mouse cursor is currently located.

### Segment Length & Total Length

"Segment Length" displays the length of the polygon segment you're working with, between the last point you have placed and the current location of your mouse cursor. "Total length" displays the length of the entire polygon so far.

### Highlight

Provides information for the currently identified map feature. (To highlight a map feature, click the Identify button located in the bottom right corner of the map display.) The Highlight field will also display the Record ID of the polygon when the mouse "hovers" over it.

Now that you know how to interact with the different components of IMAP, **LET'S GET STARTED!** The following pages outline a step-by-step walkthrough on adding new polygons to your database, as well as viewing, deleting, and modifying your currently active district polygons.

## VIEWING A POLYGON

After registering and logging in, the main menu will appear. Select **EDIT MEMBER MAP**. This will bring you to IMAP.

### Location Information Screen

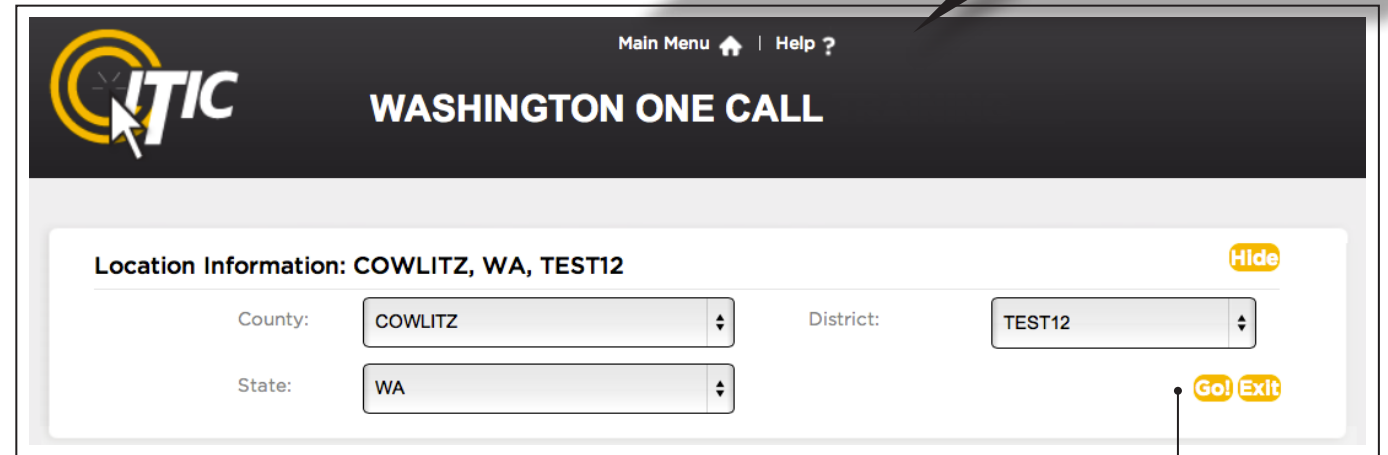

1. Select the state, county and district code you would like to work with in the Location Information section at the top of the screen.

2. Click on **GO!** at the right side of the screen. The Districts box will display all active district polygons currently on record within the county you have selected.

### Districts Box

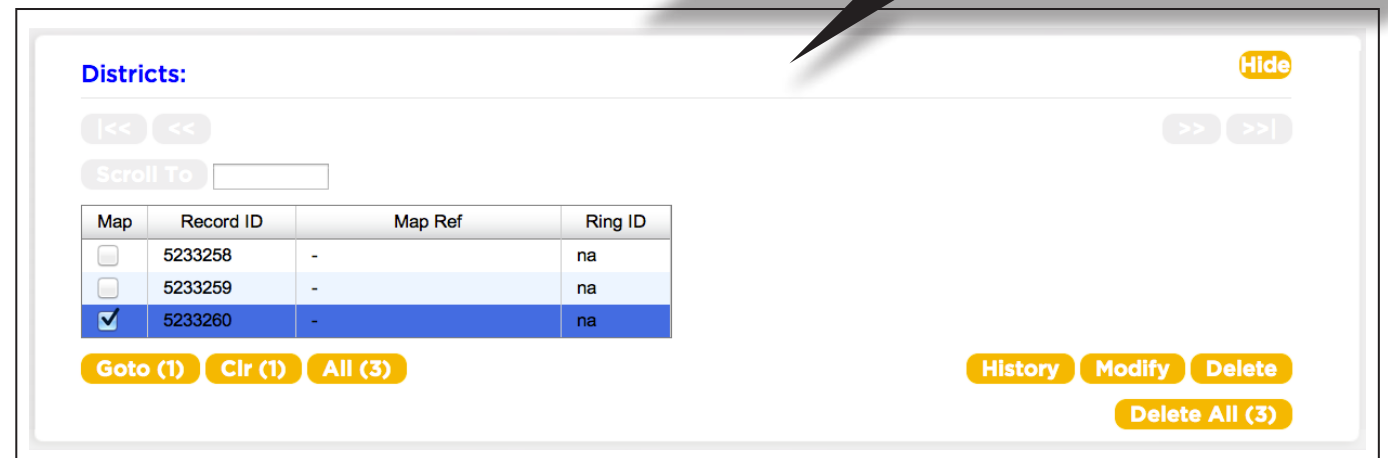

3. When in the Districts box, select the record ID of the polygon you wish to view by clicking on the check-box underneath the "Map" column for that record ID. Notice the polygon you have selected now appears in blue on the map. To get a closer look at the polygon you have selected, click the **GOTO** button located in the bottom-left corner of the Districts Box.

## VIEWING A POLYGON (Continued)

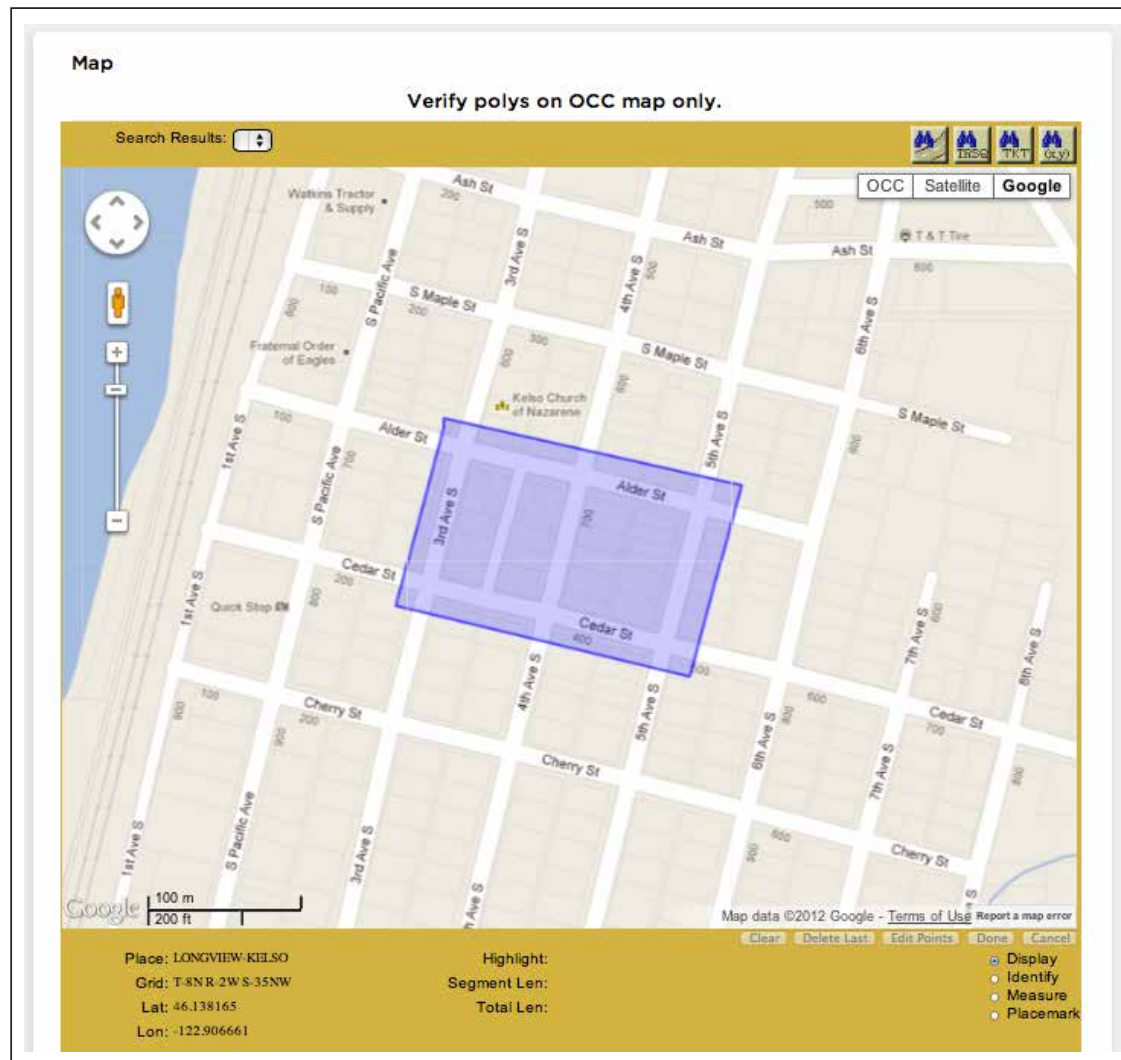

**Important:** The changes you make to your district polygons in IMAP do not go into effect immediately. All transactions must pass through the Work In Progress and To Be Verified steps. Once they appear in the Committed box, the call center computer installs them in the database within the next few days. We will send you an email notifying you that the changes have become active.

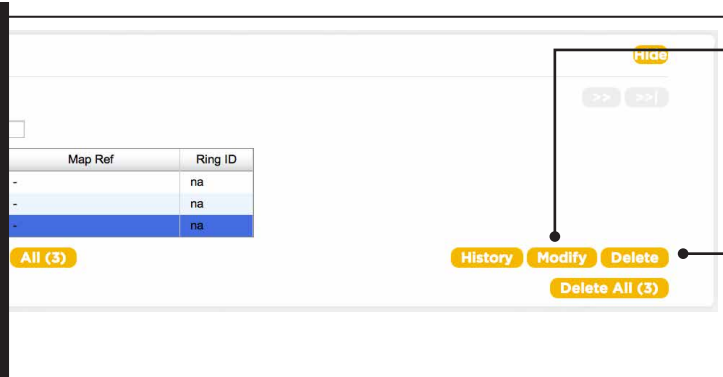

4. At this point, you can choose **MODIFY** to change the boundaries of the district polygon, or **DELETE** to remove the polygon from our system.

## VIEWING A POLYGON (Continued - Alternate Method)

Don't have your specific Record ID number? That's ok - Here's an **Alternate** way to view your District Polygons.

1. When in the **Districts** box, click the **All** button, then the **Goto** button to display all active polygons. Notice the polygons selected now appear in **blue** on the map. Zoom in to get a closer look at the polygons.

2. Once you have found the polygon you are looking for, click on it to display its corresponding Record ID.

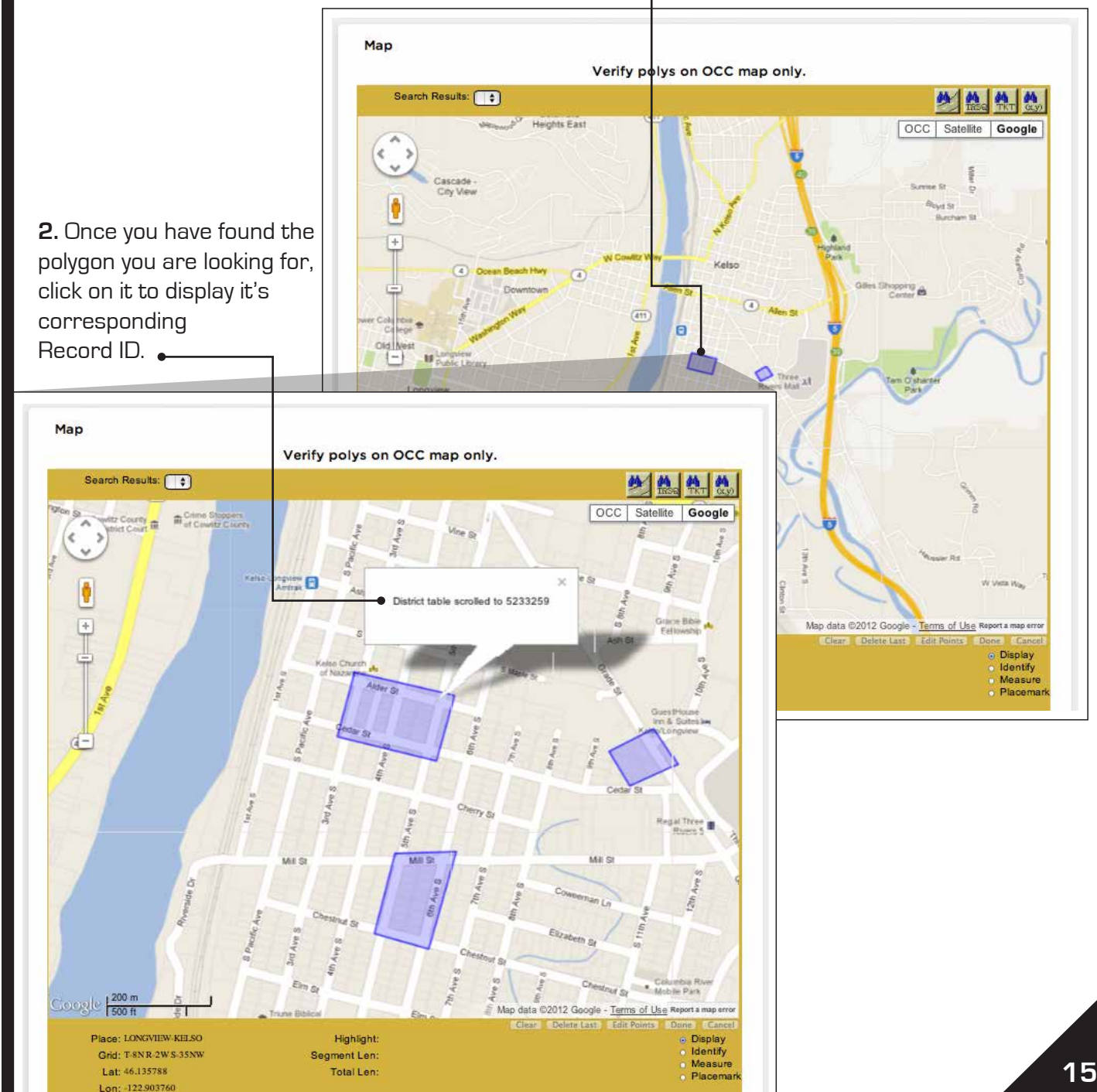

## ADDING A POLYGON

1. To begin adding a new polygon to the database, first navigate in the map to the selected area.

**Work In Progress Box**

**Work In Progress:**

<<
>>
<<<
>>>

Scroll To

Map	Type	Record ID	Map Ref	Eval Server	Act Date	User	Comments
<input type="checkbox"/>	ADD	3	-		11/30/2012	test@occinc.com	New
<input checked="" type="checkbox"/>	ADD	4	-		11/30/2012	test@occinc.com	New
<input type="checkbox"/>	ADD	5	-		11/30/2012	test@occinc.com	New
<input type="checkbox"/>	ADD	9	-		11/30/2012	test@occinc.com	New
<input type="checkbox"/>	ADD	10	-		11/30/2012	test@occinc.com	New

Goto (1)
Clr (1)
All (6)

History
New
Edit
Submit
Abort

Submit All (6)
Abort All (6)

2. Click the **NEW** button at the bottom of the **Work In Progress** box.

**Map Display - MAP view (Google)**

Verify polys on OCC map only.

3. Start drawing the polygon by clicking on the map where you would like to begin. Then release the button and move the mouse in the desired direction. **Click and Release** each time you would like to make another line of the polygon.

Refer to the 'Segment Length' and 'Total Length' displays in the lower portion of the map to ensure that the proper footage is mapped.

## ADDING A POLYGON (Continued)

4. Continue until the entire area needed is covered.

**Map Display - MAP view (Google)**

Verify polys on OCC map only.

6. Once you have drawn the polygon, click the button labeled **Done** in the bottom right corner of the map. This will bring up a window labeled **Transaction from District Polygon Information**. You may enter a date you would like the change to go into effect by either manually entering it (in MM/DD/YYYY format) or selecting it from the **calendar button**. The new polygon will be installed on that date or as soon thereafter as possible. You may also enter any **comments** that might be applicable to the new polygon, if desired. Click **OK** if you are satisfied with the polygon, or hit **Cancel** to start over. After you have clicked **OK**, the new polygon transaction will appear in the list located in the **Work In Progress** box.

**Transaction From District Polygon Information**

Activation Date  Calendar icon

Map Ref

Comments

Ok
Cancel

5. To close the polygon, simply click on the first point you made on the map.

**Note:** If you make a mistake while drawing your polygon, there are several tools for correcting it, found in the bottom-right corner of the map window. The "Delete Last" button will delete the last point you placed on the map. The "Edit Points" button allows you to move any point you have already placed by "dragging-and-dropping." The "Clear" button will delete the polygon you are working on completely, allowing you to start over. Finally, clicking "Cancel" will cancel the transaction entirely.

**IMPORTANT:** You can only draw new polygons that are completely contained within the county you are currently viewing. [See Appendix 'A1' for more details]

## DELETING A POLYGON

1. Select the polygon that you wish to delete from the list in the Districts box.

**Districts Box**

Districts: Hide

|<< << >> >>|

Scroll To

Map	Record ID	Map Ref	Ring ID
<input type="checkbox"/>	5073755	-	na
<input type="checkbox"/>	5073756	-	na
<input type="checkbox"/>	5073757	-	na
<input type="checkbox"/>	5073758	-	na
<input checked="" type="checkbox"/>	5073759	-	na

Goto (1) Ctr (1) All (9) History Modify Delete Delete All (9)

2. Click **DELETE**.

3. This will bring up the window labeled "Transaction From District Polygon Information." Enter the date you wish the deletion to become active, then click OK. After you have clicked OK, the Delete transaction will appear in the **Work In Progress** box.

**Transaction From District Polygon Information** ✕

Activation Date

Comments

Ok Cancel

**Work In Progress Box**

Work In Progress: Hide

|<< << >> >>|

Scroll To

Map	Type	Record ID	Map Ref	Eval Server	Act Date	User	Comments
<input type="checkbox"/>	ADD	1000000012	-		11/05/2012	briancasey@occinc.c	New
<input type="checkbox"/>	ADD	1000000014	-		11/05/2012	briancasey@occinc.c	New
<input type="checkbox"/>	ADD	1000000016	-		11/05/2012	briancasey@occinc.c	New
<input type="checkbox"/>	ADD	1000000018	-		11/05/2012	briancasey@occinc.c	New
<input checked="" type="checkbox"/>	DEL	5073759	-		11/05/2012	briancasey@occinc.c	Delete of 5073759

Goto (1) Ctr (1) All (9) History New Edit Submit Abort Submit All (8) Abort All (8)

**Remember:** The Delete transaction will still need to pass the **Work In Progress** and **To Be Verified** steps before changes can be made to the database.

## MODIFYING A POLYGON

1. Select the polygon from the list in the Districts box that you wish to modify, and click the **Goto** button to center the polygon on the map.

**Districts Box**

Districts: Hide

|<< << >> >>|

Scroll To

Map	Record ID	Map Ref	Ring ID
<input checked="" type="checkbox"/>	5233261	-	na
<input type="checkbox"/>	5233262	-	na

Goto (1) Ctr (1) All (2) History Modify Delete Delete All (2)

### Map Display - MAP view (Google)

Map Display - MAP view (Google)

Verify polys on OCC map only.

Map data ©2012 Google - Terms of Use Report a map error

Place: NORTH WHIDBEY Grid: T-32N R-1E5-37SW Segment Len:

2. Click **MODIFY**.

3. Each point on the polygon will display a square. To modify the polygon, click and hold on any point, drag it to the desired location, and release the mouse button. Continue to "drag-and-drop" until you have achieved the desired polygon shape. Single clicking on any point will delete that point.

Notice that unchanged portions of the existing polygon will stay blue, while the newly expanded/edited portion will be yellow.

## MODIFYING A POLYGON (Continued)

- Click on the **Done** button, located in the bottom-right corner of the map. This will bring up a window labeled "Transaction From District Polygon Information."

**Transaction From District Polygon Information** [X]

Activation Date:  [Calendar Icon]

Map Ref:

Comments:

[Ok] [Cancel]

Enter the date you wish the modification to become active, then click **OK**. The newly modified polygon will now appear in the **Work In Progress** box.

**Work In Progress:** [Hide]

[<<] [<<] [Scroll To: ] [>>] [>>]

Map	Type	Record ID	Map Ref	Eval Server	Act Date	User	Comments
<input type="checkbox"/>	ADD	1	-121212		11/19/2012	test@occinc.com	New
<input checked="" type="checkbox"/>	MOD	5233261	-		12/01/2012	test@occinc.com	Modify

[Goto (1)] [Clr (1)] [All (2)] [History] [New] [Edit] [Submit] [Abort] [Submit All (2)] [Abort All (2)]

### Map Display - OCC view

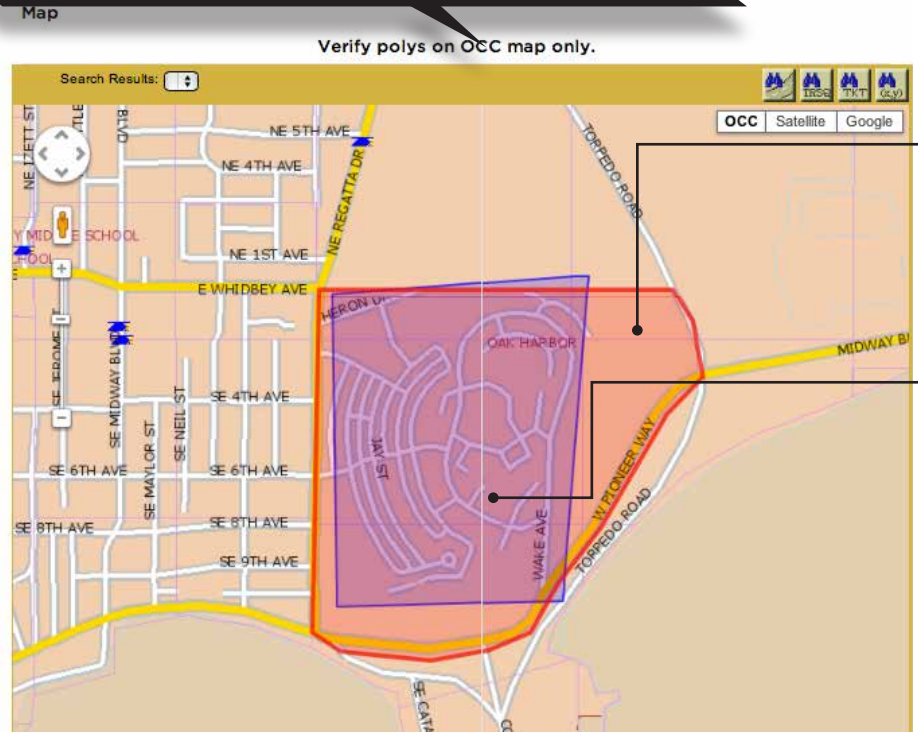

The newly modified polygon will be displayed in **red**.

The original polygon will still be displayed in **blue**.

## THE POLYGON TRANSACTION PROCESS

Any time you make any changes to your database, you create a transaction. In order for a transaction to become active, it **must** pass several steps of verification, represented by the 4 boxes located between the Location Information display and the Map display. The 4 steps (or "boxes") are:

**DISTRICTS - WORK IN PROGRESS - TO BE VERIFIED - COMMITTED**

(The **polygons** appearing in the map display are color coded to indicate in which box they reside)

### For example...

This newly created 'Modify' Transaction currently resides in the **Work In Progress** box. Clicking **Submit** will

**Submit**

pass the transaction to the **To Be Verified** box.

**Work In Progress:** [Hide]

[<<] [<<] [Scroll To: ] [>>] [>>]

Map	Type	Record ID	Map Ref	Eval Server	Act Date	User	Comments
<input type="checkbox"/>	ADD	1	-121212		11/19/2012	test@occinc.com	New
<input checked="" type="checkbox"/>	MOD	5233261	-		12/01/2012	test@occinc.com	Modify

[Goto (1)] [Clr (1)] [All (2)] [History] [New] [Edit] [Submit] [Abort] [Submit All (2)] [Abort All (2)]

Clicking **Approve** will

**Approve**

submit the transaction to the call center for processing.

**To Be Verified:** [Hide]

[<<] [<<] [Scroll To: ] [>>] [>>]

Map	Type	Record ID	Map Ref	Eval Server	Act Date	User	Comments
<input checked="" type="checkbox"/>	MOD	5233261	-		12/01/2012	test@occinc.com	Submit

[Goto (1)] [Clr (1)] [All] [History] [Approve] [Reject] [Approve All (1)] [Reject All (1)]

(It will also appear in the **Committed** box.)

**Committed:** [Hide]

[<<] [<<] [Scroll To: ] [>>] [>>]

Map	Type	Record ID	Map Ref	Eval Server	Act Date	User	Comments
<input checked="" type="checkbox"/>	MOD	5233261	-		12/01/2012	test@occinc.com	Approve

[Goto (1)] [Clr (1)] [All] [History]

Once the transactions are listed in the **To Be Verified** box, you will need to carefully verify the changes to ensure they are accurate. After approving the transactions, they will be listed in the **Committed** box, indicating to the call center you're ready for the changes to go into effect. Remember, the transaction will go into effect according to the activation date, not immediately after you have committed it. **You will receive an email notification when you commit the transaction, and ANOTHER once the transaction has gone into effect.**

The following pages explain the transaction 'boxes' and their functionality.

## THE POLYGON TRANSACTION PROCESS (Continued)

### Districts

The Districts box contains a complete list of all currently active polygons matching the county and district code you selected in the Location Information section. In the Districts box you can view, modify or delete any of your currently active district polygons. When you select a polygon from the Districts list (by clicking the check box located to the far left of the list) it will appear on the map in blue, signifying it as an unmodified district polygon. When you choose to Modify or Delete an active polygon, a transaction is created, and will appear under the Work In Progress tab.

**NOTE:** It is common for District polygons and polygons from other boxes to overlap each other. You may go to the appropriate box (Districts, Work In Progress, To Be Verified, or Committed) and click **CLR** for the polygons you wish to stop being displayed on the map.

**Districts Box**

**Districts:**

|<< << >> >>|

Scroll To

Map	Record ID	Map Ref	Ring ID
<input checked="" type="checkbox"/>	5233261	-	na
<input type="checkbox"/>	5233262	-	na

Goto (1) Clr (1) All (2)
History Modify Delete
Delete All (2)



Polygons that appear in the Districts box will be displayed in **BLUE** on the map.

## THE POLYGON TRANSACTION PROCESS (Continued)

### Work In Progress

The Work In Progress box contains a list of transactions - polygons that are in the process of being newly created, modified or deleted. Any transactions that began in the Districts box will appear here next. In the Work In Progress box you can create new district polygons ("New"), submit existing polygon transactions to the To Be Verified box ("Submit"), or cancel existing polygon transactions entirely ("Abort"). You can also modify any polygon transactions listed here ("Edit").

**Work In Progress Box**

**Work In Progress:** Hide

|<< << >> >>|

Scroll To

Map	Type	Record ID	Map Ref	Eval Server	Act Date	User	Comments
<input type="checkbox"/>	ADD	1	-121212		11/19/2012	test@occinc.com	New
<input checked="" type="checkbox"/>	MOD	5233261	-		12/01/2012	test@occinc.com	Modify

Goto (1) Clr (1) All (2)
History New Edit Submit Abort
Submit All (2) Abort All (2)

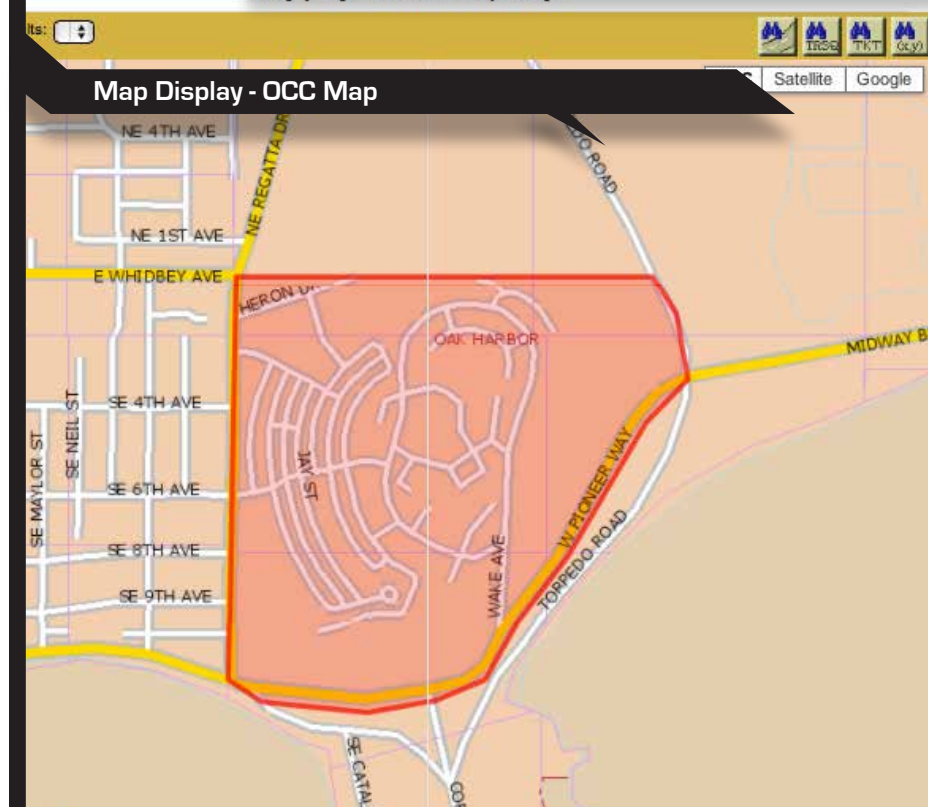

Polygons that appear in the Work in Progress box will be displayed in **RED** on the map.

## THE POLYGON TRANSACTION PROCESS (Continued)

### To Be Verified

The To Be Verified box contains a list of polygons that have “passed” the previous Districts and Work In Progress steps, and are waiting for final verification or rejection. Here you can either Approve a transaction, which will submit the polygon for inclusion in the database, or Reject a transaction, which will bounce it back to the **Work In Progress** box.

**To Be Verified Box**

To Be Verified: Hide

Navigation: |<< << >> >>|

Scroll To:

Map	Type	Record ID	Map Ref	Eval Server	Act Date	User	Comments
<input checked="" type="checkbox"/>	MOD	5233261	-		12/01/2012	test@occinc.com	Submit

Buttons: Goto (1) Clr (1) All History Approve Reject Approve All (1) Reject All (1)

Map Display - OCC Map

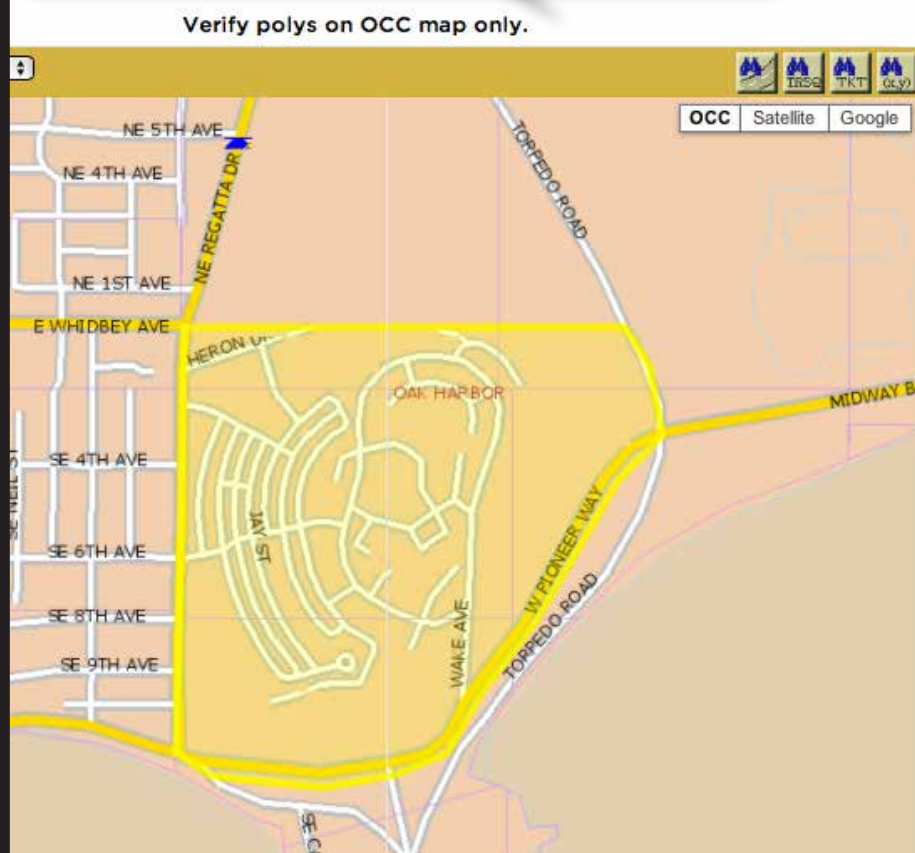

Polygons that appear in the To Be Verified box will be displayed in **YELLOW** on the map.

## THE POLYGON TRANSACTION PROCESS (Continued)

### Committed

The Committed box contains a list of all polygon transactions that have been fully approved. Once the polygon has passed the final step of verification (the **To Be Verified** section), a record of the transaction will appear in this section so that you can view a list of all polygons that have been added, edited, or deleted. Once the transactions have been installed, the polygons will no longer be listed here, and will be displayed in the Districts box (unless deleted).

**Committed Box**

Committed: Hide

Navigation: |<< << >> >>|

Scroll To:

Map	Type	Record ID	Map Ref	Eval Server	Act Date	User	Comments
<input checked="" type="checkbox"/>	MOD	5233261	-		12/01/2012	test@occinc.com	Approve

Buttons: Goto (1) Clr (1) All History

Map Display - OCC Map

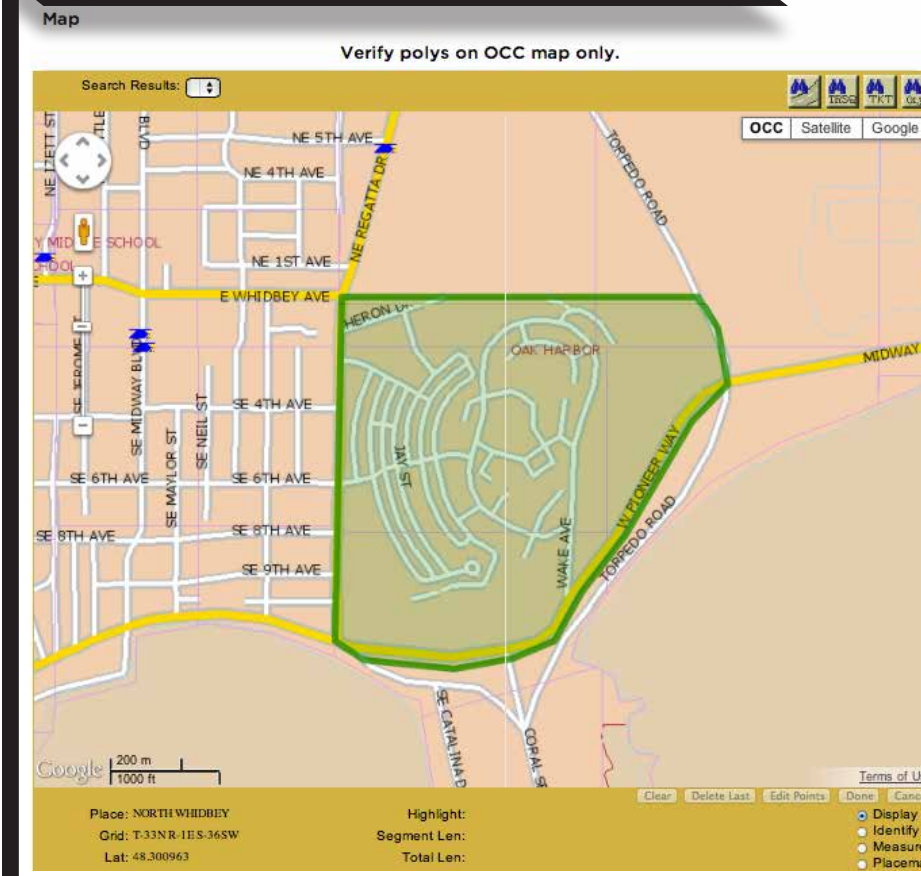

Polygons that appear in the Committed box will be displayed in **GREEN** on the map.

**REMINDER:** Always check your work before approval. Once the change goes into effect it can take a few days to correct it. For security and accuracy, limit who can edit your database. It is always better to have one person make the change and another to check and approve the work.

## Exiting IMAP

After all changes have been made and submitted, exit IMAP by clicking on the **EXIT** button in the upper right corner of the screen. This will then take you back to the main menu and you can logout.

## Activation Date for New or Changed Polygons

Your polygons may or may not be installed on the actual date you requested for activation. Updates are done daily Monday through Friday (excluding holidays). Changes are installed on the requested date or as soon thereafter as possible. If you have not received an email confirmation of your polygon submissions within one week of your selected activation date, please call **877-668-4001**.

Questions? Comments? Suggestions? Feel free to contact the Utility Notification Center Database Department at [NWDATABASE@OCCINC.COM](mailto:NWDATABASE@OCCINC.COM), or call **877-668-4001**.



## Polygons Drawn Outside County Boundaries

You can only draw new polygons that are completely contained within the county you are currently viewing (county boundaries are visible in the OCC map view). **IMPORTANT:** If you attempt to draw a polygon that extends beyond the county boundaries, the computer will “clip” the outlying portions of your polygon, and you will see [this pop-up item](#).

If you want your notification area to extend into another county, you must create a new polygon in the other county that continues your notification area.

Polygon as drawn by the user – note the sections extending outside the currently selected county.

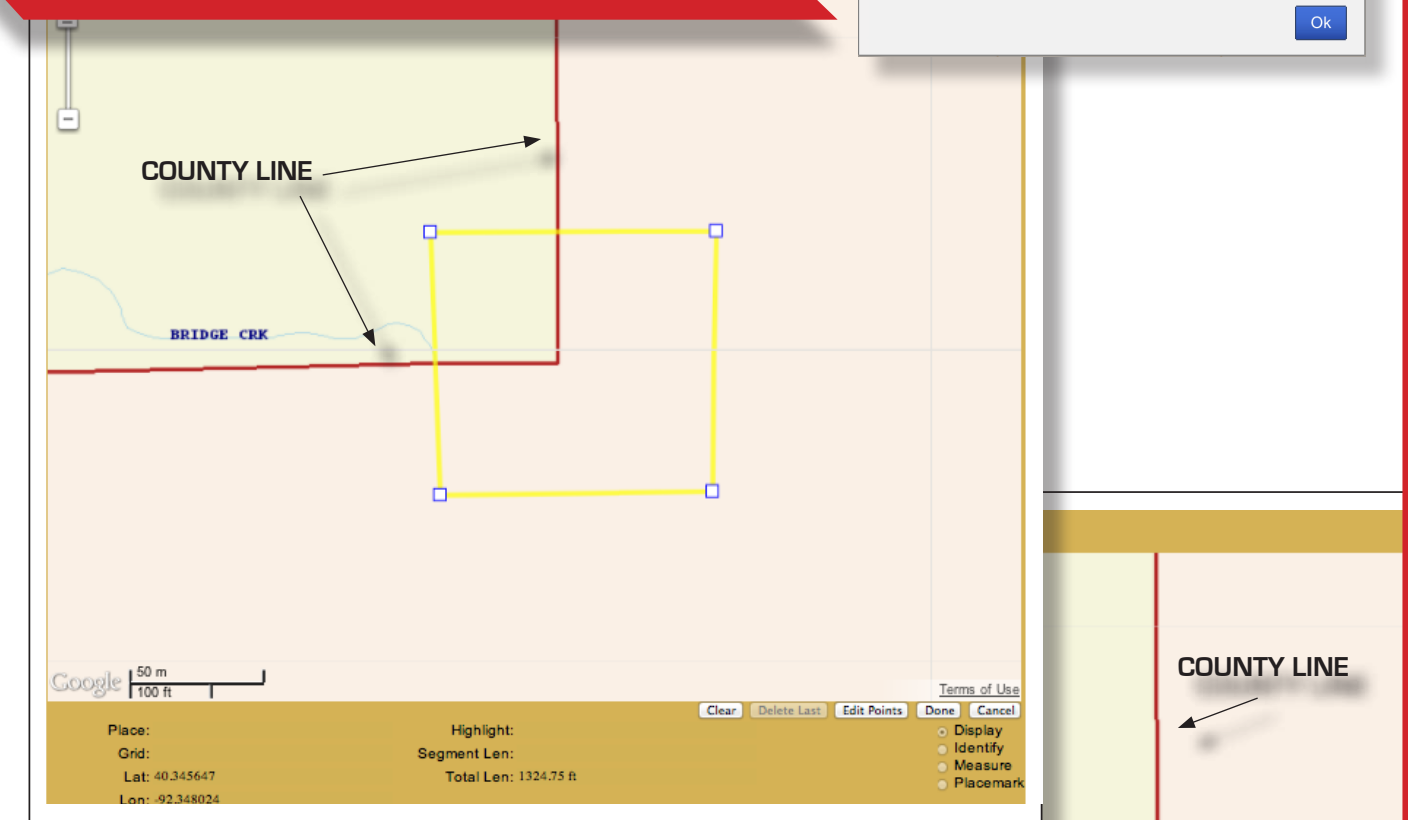

Polygon after ‘clipping’ – all sections of the polygon originally drawn outside of the county have been removed.